

Manual KT048

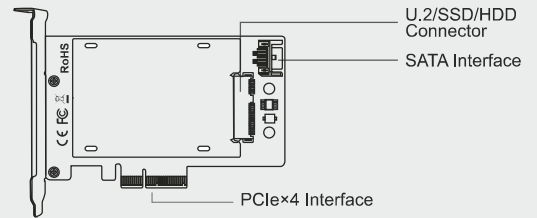
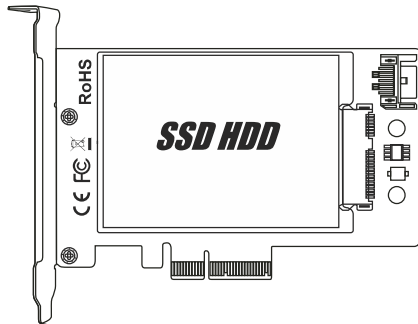

Product:	PCIe zu U.2/SATA Express Card
Supports:	U.2 SSD and 2.5" SATA I / II / III SSD/HDD
Interface:	PCIe x4 3.0 to U.2/SFF-8639
Power:	PCIe
Size:	153 (l) *120 (w) *22 (h) MM
OS:	up from Win8.1
Hardware:	At least one PCIe x4/x8/x16 slot

①

General information

Please read the instructions carefully and pass them on to the new owner when you pass on the product to a new owner.

Intended use

This product is intended exclusively for the installation of hard disks and connection to computers in closed rooms.
Do not use or store the product in damp rooms or near water.

Dangers and protective measures

Do not apply any external forces to the product.
Do not operate the appliance with wet hands (may lead to corrosion or damage).
Despite careful checks, sharp edges or corners may remain on the metal parts.
Please take this into account to avoid injury.
Product contains small screws for fastening the hard disk. Keep these small parts away from children.

Maintenance

In principle, the appliance does not require any maintenance; in the event of dust or dirt, wipe it off with a dust cloth.

Disposal

If you want or need to replace the product, please do not dispose of it with household waste, but via the special collection points for old electrical appliances. If you have any questions, please contact your local authority or ask your specialist dealer.
Please dispose of cardboard and plastic packaging waste in the appropriate collection containers for household waste.

Warranty conditions

We grant a 12-month guarantee on our product from the date of purchase, subject to proper use. To process the warranty claim, please contact your specialist dealer with your proof of purchase. Please refer to our website at www.inter-tech.de - Service&Support - Information - Warranty conditions for the full conditions and exclusions.

Preparation

Remove the product from the packaging and check it for damage or missing parts. If, despite careful inspection, there is any damage or missing parts, please contact the dealer from whom you purchased the device.

Note

If you are using an unformatted hard disk, it must first be formatted and partitioned before use. To do this, start the disk management of your computer.

If you are not familiar with these steps, please ask a specialist for help, as formatting the wrong data carrier can damage your operating system or delete important data.

Contact

Inter-Tech Elektronik Handels GmbH
Hainhäuser Weg 93 D-30855 Langenhagen, Germany
vertrieb@inter-tech.de

③

Installation

I. 2.5" SATA/SAS

- ① Plug the 2.5" SATA HDD/SSD into the card
- ② Fasten it with four screws
- ③ Connect a 7pin SATA cable to the card and mainboard
- ④ Insert the card into a PCIe x4 slot
- ⑤ Fix the card on the case

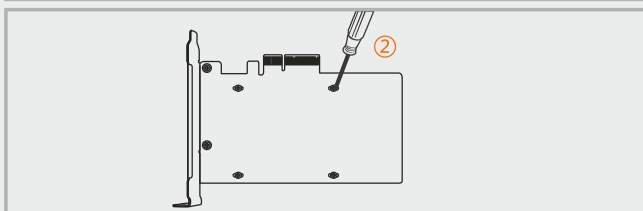
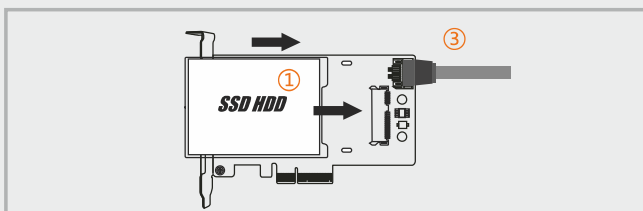

④

II. U.2 SSD

- ① Plug the 2.5" SATA HDD/SSD into the card
- ② Fasten it with four screws
- ④ Insert the card into a PCIe x4 slot
- ⑤ Fix the card on the case

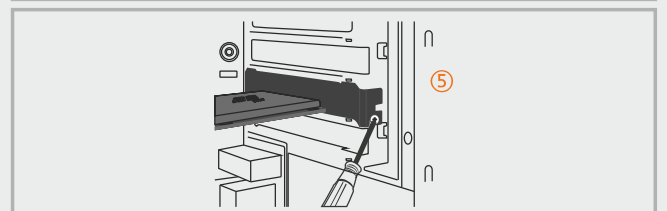
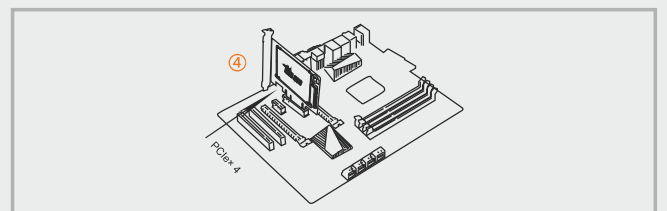

⑤